

Original instructions

Safety Contact Edges

GE-Series, GP-Series



Read and understand this document

Please read and understand this document before using the products. Please consult your ABB JOKAB SAFETY representative if you have any questions or comments.

WARRANTY

ABB JOKAB SAFETY's exclusive warranty is that the products are free from defects in materials and workmanship for a period of one year (or other period if specified) from date of sale by ABB JOKAB SAFETY.

ABB JOKAB SAFETY MAKES NO WARRANTY OR REPRESENTATION, EXPRESSED OR IMPLIED, REGARDING NON-INFRINGEMENT, MERCHANTABILITY, OR FITNESS FOR PARTICULAR PURPOSE OF THE PRODUCTS, ANY BUYER OR USER ACKNOWLEDGES THAT THE BUYER OR USER ALONE HAS DETERMINED THAT THE PRODUCTS WILL SUITABLY MEET THE REQUIREMENTS OR THEIR INTENDED USE. ABB JOKAB SAFETY DISCLAIMS ALL OTHER WARRANTIES, EXPRESSED OR IMPLIED.

LIMITATIONS OF LIABILITY

ABB JOKAB SAFETY SHALL NOT BE RESPONSIBLE FOR SPECIAL, INDIRECT, OR CONSEQUENTIAL DAMAGES, LOSS OF PROFITS OR COMMERCIAL LOSS IN ANY WAY CONNECTED WITH THE PRODUCTS, WHETHER SUCH CLAIM IS BASED ON CONTRACT, WARRANTY, NEGLIGENCE, OR STRICT LIABILITY.

In no event shall responsibility of ABB JOKAB SAFETY for any act exceed the individual price of the product on which liability asserted.

IN NO EVENT SHALL JOKAB SAFETY BE RESPONSIBLE FOR WARRANTY, REPAIR, OR OTHER CLAIMS REGARDING THE PRODUCTS UNLESS JOKAB SAFETY'S ANALYSIS CONFIRMS THAT THE PRODUCTS WERE PROPERLY HANDLED, STORED, INSTALLED, AND MAINTAINED AND NOT SUBJECT TO ABUSE, MISUSE, OR INAPPROPRIATE MODIFICATION OR REPAIR.

SUITABILITY FOR USE

ABB JOKAB SAFETY shall not be responsible for conformity with any standards, codes, or regulations that apply to the combination of products in the customer's application or use of the product. At the customer's request, ABB JOKAB SAFETY will provide applicable third party certification documents identifying ratings and limitations of use that apply to the products. This information by itself is not sufficient for a complete determination of the suitability of the products in combination with the end product, machine, system, or other application or use.

The following are some examples of applications for which particular attention must be given. This is not intended to be an exhaustive list of all possible uses of the products, nor is it intended to imply that the uses listed may be suitable for the products:

Outdoor use, uses involving potential chemical contamination or electrical interference, or conditions or uses not described in this document.

Nuclear energy control systems, combustion systems, railroad systems, aviation systems, medical equipment, amusement machines, vehicles, and installations subject to separate industry or government regulations.

Systems, machines, and equipment that could present a risk to life or property.

Please know and observe all prohibitions of use applicable to the products.

NEVER USE THE PRODUCTS FOR AN APPLICATION INVOLVING SERIOUS RISK TO LIFE OR PROPERTY WITHOUT ENSURING THAT THE SYSTEM AS A WHOLE HAS BEEN DESIGNED TO ADDRESS THE RISKS, AND THAT THE JOKAB SAFETY PRODUCT IS PROPERLY RATED AND INSTALLED FOR THE INTENDED USE WITHIN THE OVERALL EQUIPMENT OR SYSTEM.

PERFORMANCE DATA

While every effort has been taken to ensure the accuracy of the information contained in this manual ABB JOKAB SAFETY cannot accept responsibility for errors or omissions and reserves the right to make changes and improvements without notice. Performance data given in this document is provided as a guide for the user in determining suitability and does not constitute a warranty. It may represent the result of JOKAB SAFETY'S test conditions, and the users must correlate it to actual application requirements. Actual performance is subject to the ABB JOKAB SAFETY Warranty and Limitations of Liability.

Table of Contents

1	Introduction	4
	Scope	4
	Audience	4
	Prerequisites	4
	Special notes	4
2	Overview	5
	General description	5
	Safety regulations	5
3	Installation and maintenance	6
	Contact Edge GE – General	6
	Assembly Instructions for the GE-series	6
	Contact Edge GP – General	13
	Safety contact edge, construction	13
	Safety contact strip SKS 18	13
	Contact Edge GP – Installation	14
4	Connections	16
	Installation precautions	18
	Maintenance	18
5	Model overview	19
6	Technical data	21
7	EC Declaration of conformity	25

1 Introduction

Scope

The purpose of these instructions is to describe the safety contact edges and to provide the necessary information required for installation and use.

Audience

This document is intended for authorized installation personnel.

Prerequisites

It is assumed that the reader of this document has knowledge of the following:

- Basic knowledge of ABB Jokab Safety products.
- Knowledge of machine safety.

Special notes

Pay attention to the following special notes in the document:

 **Warning!** Danger of severe personal injury!
An instruction or procedure which, if not carried out correctly, may result in injury to the technician or other personnel.

Caution! Danger of damage to the equipment!
An instruction or procedure which, if not carried out correctly, may damage the equipment.

NB: Notes are used to provide important or explanatory information.

2 Overview

General description

Contact edges are used as protection against crushing injuries for example, moving machine parts or automatic doors.

This manual describes Contact edges with cast-in contact strips (GE) and Contact edges with contact strips SKS 18 (GP).

The contact edges GE consist of a rubber profile with a cast-in contact strip. They are made up simply using connection plugs that are glued to the ends together with a terminal cap. The rubber profile is fitted on an aluminium profile. The rubber profile is available in EPDM design.

The contact edges GP consist of a rubber profile with a safety contact strip, SKS 18, inside. The contact edge is fitted on an aluminium profile. The rubber profile is available in EPDM or NBR.

Safety regulations

Warning!

Carefully read through this entire manual before using the device.

The devices shall be installed by a trained electrician following the Safety regulations, standards and the Machine directive.

Failure to comply with instructions, operation that is not in accordance with the use prescribed in these instructions, improper installation or handling of the device can affect the safety of people and the plant.

For installation and prescribed use of the product, the special notes in the instructions must be carefully observed and the technical standards relevant to the application must be considered.

In case of failure to comply with the instructions or standards, especially when tampering with and/or modifying the product, any liability is excluded.

3 Installation and maintenance

Contact Edge GE – General

Inside the contact edge there is a cast-in contact strip that consist of two conductive alternating surfaces on the inside and a highly-effective insulation shell. There are two conductive wires in the contact surfaces that allow for low ohm measurements even when the contact edge has an extended length. The cast-in contact strip is protected against damage by the surrounding chamber. The cast end plugs ensure a permanent contact from the conductive surfaces in the contact strip. A special flexible adhesive is used to make the connector ring watertight. Because of the contact points, the safety contact edge has approximate 20 mm of inactive length at each end. Assembly of the contact edge GE can be made by the customer or chosen to be manufactured by the ABB Jokab Safety factory.

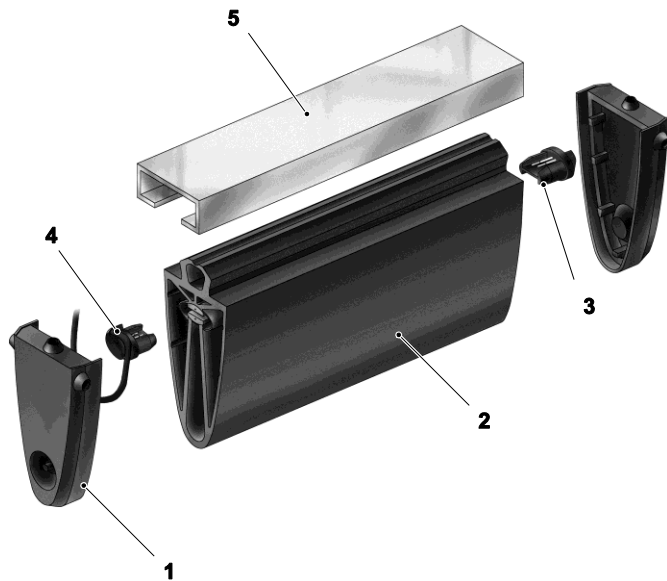

1. Terminal cap
2. Rubber profile with integrated contact strip
3. Terminal resistor (Can be connection plug with cable as well)
4. Connection plug
5. Aluminium profile

Assembly Instructions for the GE-series

1. Cutting the safety-contact-edge

The contact edge is to be cut to correct length (cut measure). It is to be noted that the planes of section are right-angled and smooth. The measure should be 25 mm shorter than the final dimension of the finished contact edge (height of end caps). (A = Cut measure, B= Final measure)

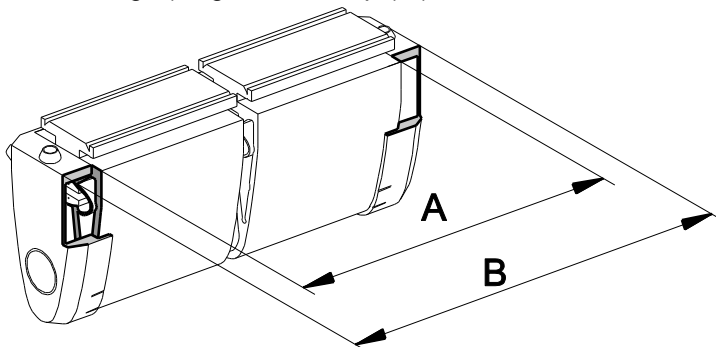

2. Preparing the wiring plug and end caps

Puncture the appropriate cable entry of the end cap, by which the cable is implemented, with a screw-driver (\varnothing 3-5mm). Pull the cable through this cable entry. The arrangement of the individual components depends on the respective gate construction and on structural conditions, which must be considered with.

For manufacturing a contact edge with sealing rims, the end caps must be cut out in the marked places for the withdrawal of the sealing rims.

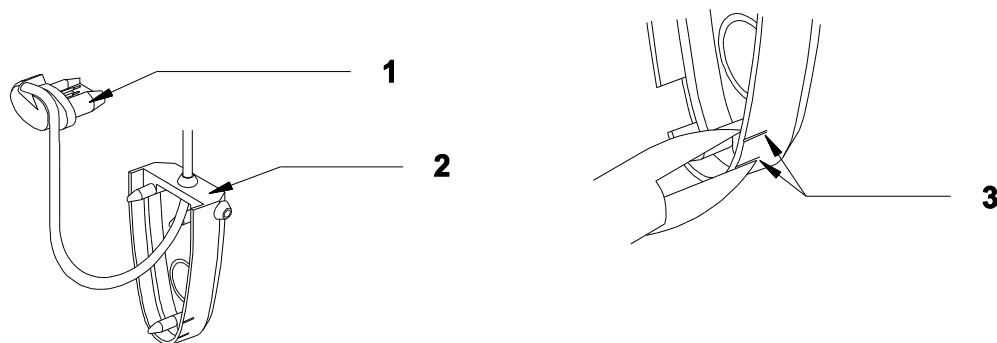

- 1) Wiring plug
- 2) End Cap
- 3) Marks

3. Contacting

Press the wiring plug with the drawn up end cap and the termination plug onto the appropriate side of the contact edge in each case up to the half into the switching chamber. The respective putting in direction of the plugs is to be considered. Make sure that the needle is pricked appropriate into the copper braids of the switching chamber.

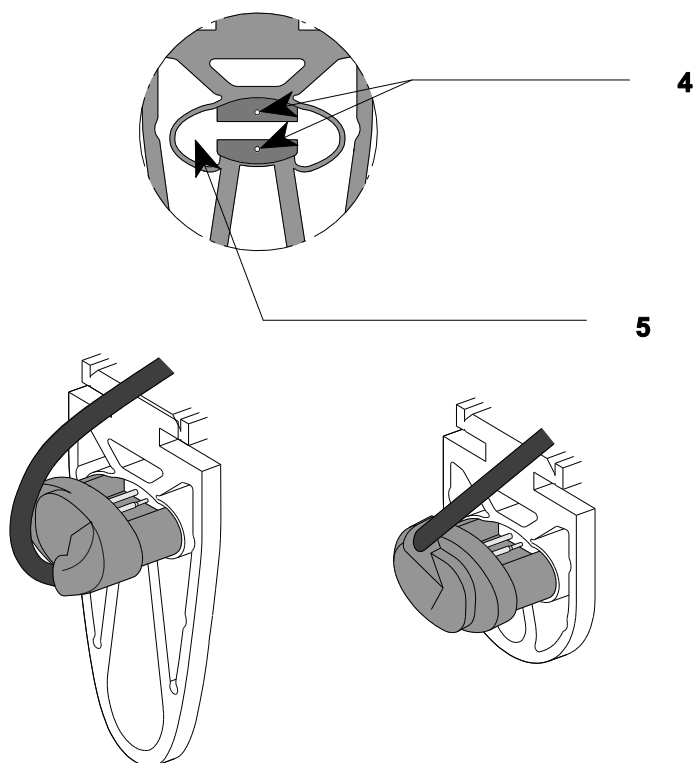

- 4) Copper braid
- 5) Switching chamber

4. Testing

Measure the plugger together with the contact edge with a commercial resistance measuring instrument. The resistance between blue-blue (out form each end) or brown-brown wire is to be as low as possible, not exceeding 10 ohms. With no load on the safety edge, resistance between blue-brown wires (both combinations) is to be as high as possible, not below 10.000 ohms. With loaded edge, the resistance should be between 10–50 ohms.

The resistance will vary with pressure applied and distance from ends. Close to the ends, it may be possible to achieve “contact” at a high force but this should not be considered as safe operation. Normally there will be a “dead zone” approximately 20–30 mm from each end.

If the resistance values should not be correct, the wiring plugs must be removed and pressed in again.

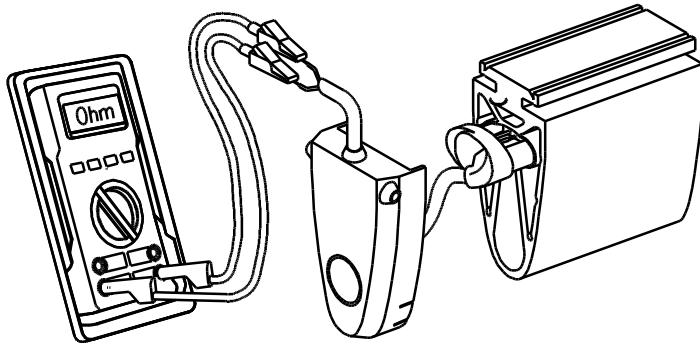

5. Gluing the wall plugs

The ambient temperature during glueing should be between 10° and 30°C and the relative humidity between 40 and 70%. Coat the surfaces of the wiring plugs and the switching chamber which will be stuck together with the CA-Primer. Provide the wiring plug all around with glue „Contact VA 250 black“. Immediately after that, press the plug strongly into the switching chamber (if available by using the auxiliary tool). The steps are to be repeated for the termination plug or connection plug in the other end.

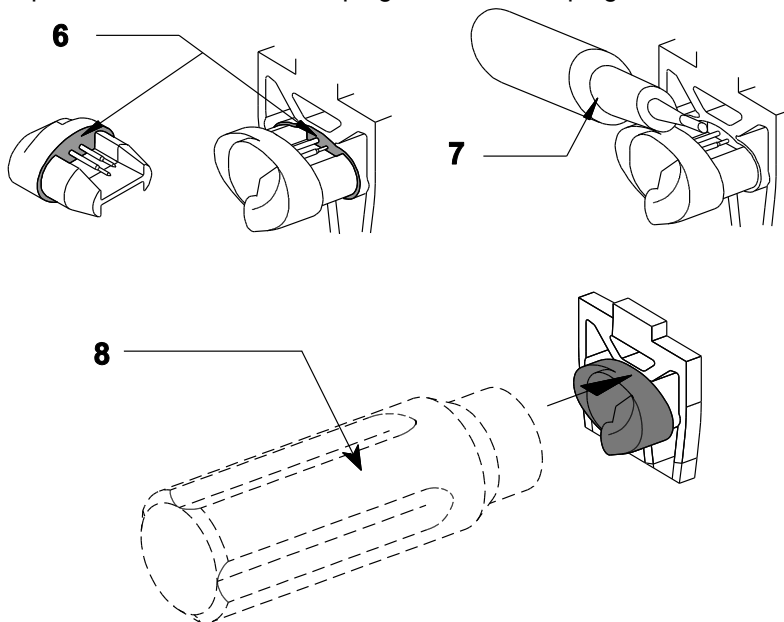

- 6) Primer
- 7) Glue
- 8) Auxiliary tool

6. Gluing the end caps

Coat the surfaces of the contact edge and the end cap which will be stuck together with the CA-Primer. For an accelerated adhesion the surfaces of the end cap can be coated additionally with an activator. Provide the front surface and the circulating outline surface of the contact edge with glue „Contact VA 250 black“. Turn the end cap over the contact edge and immediately press the cap evenly (Keep pressed, until the glue works). The steps are to be repeated for the second cap.

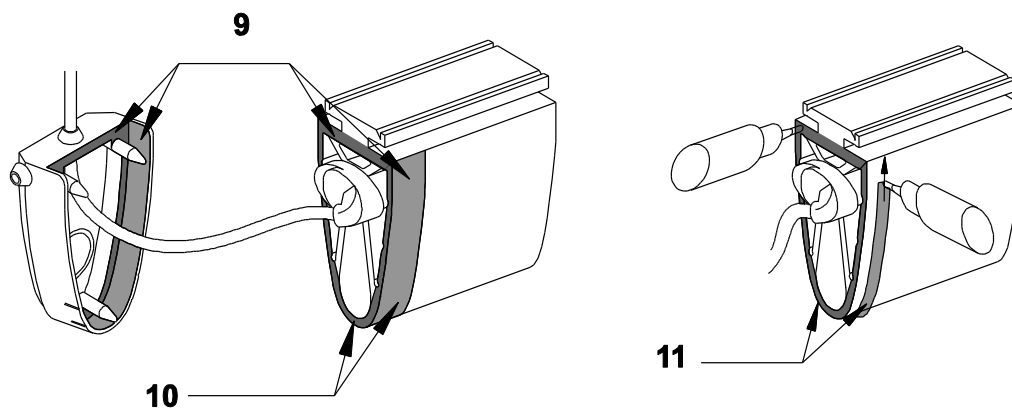

- 9) Primer
- 10) Activator
- 11) Glue

7. Measuring the contact edge

Measure the finished manufactured contact edge as described under point 4.

8. Water drain

For a long life span of a vertical installed contact edge it is important to provide a water drain. For this the marked lower water outlet is to be cut out. When horizontal assembling both openings should be cut out. Use a knife to cut out the holes but wait until the glue has hardened enough (2–3 h).

Assembly instructions for GE-series

1. To facilitate installation of the safety contact edge, the aluminium C-profile may only be attached to even surfaces. If the safety contact edge is mounted in a bend, the radius must not be less than the specified minimum.

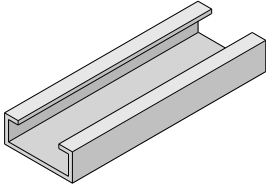

2. The aluminium C-profile must be fitted with countersunk screws or rivets. A diameter of 4 mm is sufficient. The holes of 4.5 mm must be evenly distributed over the entire length of the C-profile with distances between them not exceeding 300 mm. They have to be countersunk according to the screw size.

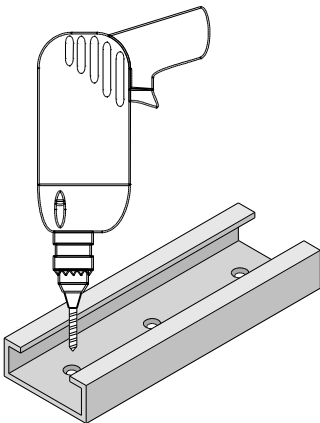

3. Pan- or round-head screws should not be used. Otherwise the connecting wire in the aluminum C-profile could be damaged.

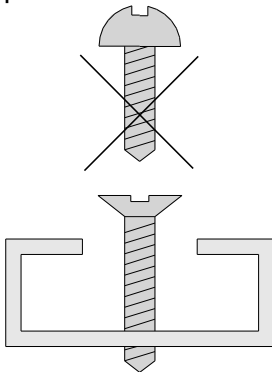

4. In order to lead the connecting wire through the C-profile, an 8 mm hole has to be drilled in the appropriate place. Carefully remove the burr from both sides.

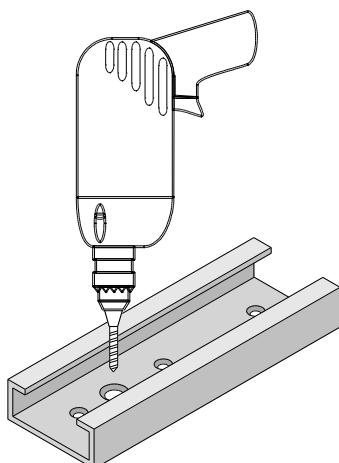

5. The connecting wire and the 30 cm cable end with the integrated terminal resistor can be placed in the aluminium C-profile.

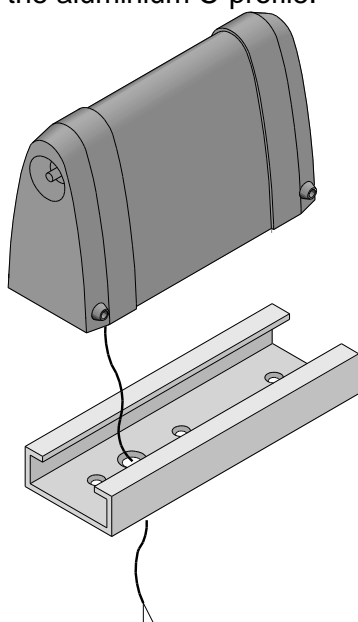

6. In order to make fitting the safety contact edge easier, the aluminium C-profile and the safety contact edge should be sprayed with soapy water. Once the soap suds have evaporated the contact edge is firmly fitted in the C-profile.

NB! To prevent a subsequent slipping of the safety contact edge talcum powder, oils or similarly durable lubricants may not be used!

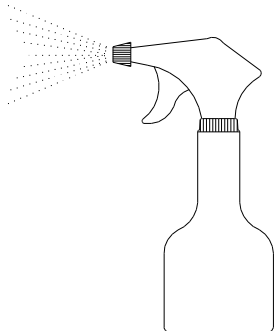

7. Safety contact edges with a c-base have to be clipped with one side into the C-profile. Then press in the complete C-base. Pulling or pushing the safety contact edge into the aluminium C-profile can cause damage to the contact edge and should be avoided at all costs.

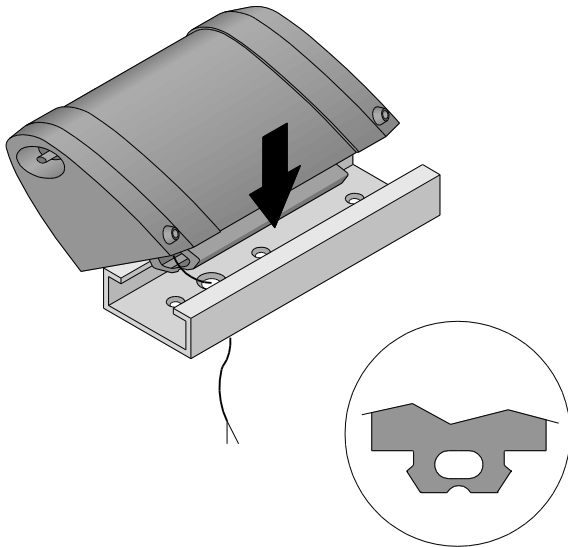

8. Safety contact edges with a T-base have to be pushed into the aluminium C-profile.

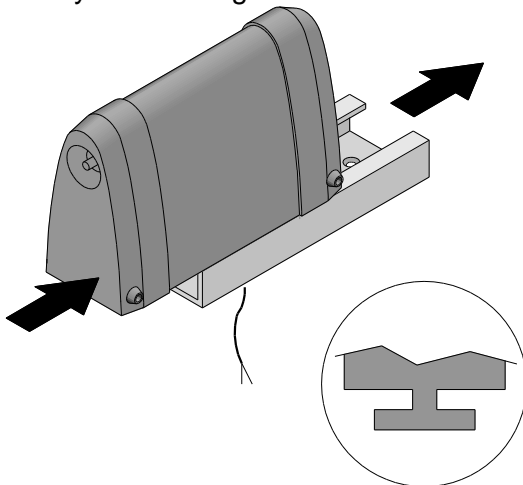

NB! Any other methods of fastenings are only permitted on prior agreement with the manufacturer!

Contact Edge GP – General

The safety contact strip, SKS 18, the actual contactor, is located inside the safety contact edge. The safety contact strip consist of a homogeneous highly insulating outer EPDM material and has two internal conducting contact surfaces. The conducting elastomer contains two copper wires that provide low-resistance detection even in lengths exceeding 100 meters (**NB!** The contact edge GP series is only possible to make in max 6 meter length). Because of the contact points, the safety contact edge has approximate 30 mm of inactive length at each end. To provide protection against damage and to enable its proper use, the safety contact strip is inserted into the switching chamber of the rubber contactor profile. The rubber profiles (EDPM or NBR) are then permanently sealed with a special elastic adhesive and end caps to make them watertight. The safety contact edge is then pressed into the aluminium profile. Assembly of the contact edge GP is always made by the ABB Jokab Safety factory.

Safety contact edge, construction

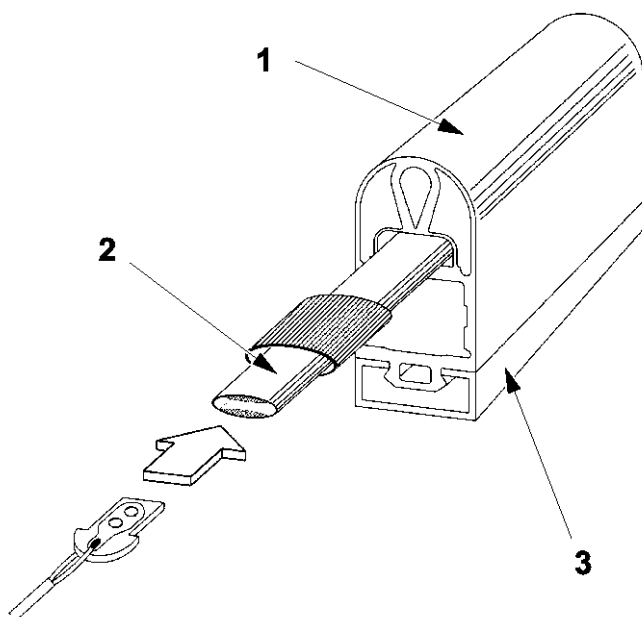

- 1) Rubber profile
- 2) SKS 18
- 3) Aluminium support profile, C-profile

Safety contact strip SKS 18

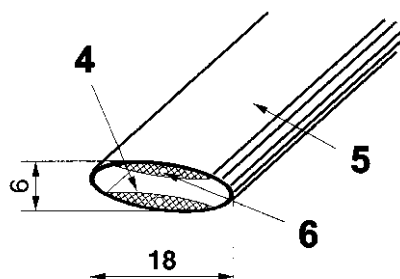

- 4) Conductive contact surface
- 5) Highly insulated outer material
- 6) Copper wire

Contact Edge GP – Installation

1. To facilitate installation of the safety contact edge, the aluminium C-profile may only be attached to even surfaces. If the safety contact edge is mounted in a bend, the radius must not be less than the specified minimum.

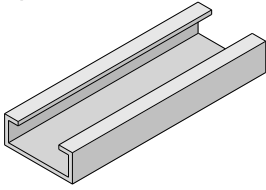

2. The aluminium C-profile must be fitted with countersunk screws or rivets. A diameter of 4 mm is sufficient. The holes of 4.5 mm must be evenly distributed over the entire length of the C-profile with distances between them not exceeding 300 mm. They have to be countersunk according to the screw size.

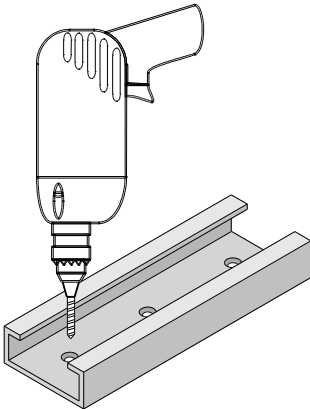

3. Pan- or round-head screws should not be used. Otherwise the connecting wire in the aluminum C-profile could be damaged.

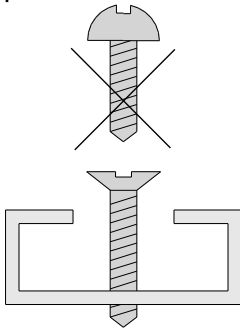

- In order to lead the connecting wire through the C-profile, an 8 mm hole has to be drilled in the appropriate place. Carefully remove the burr from both sides.

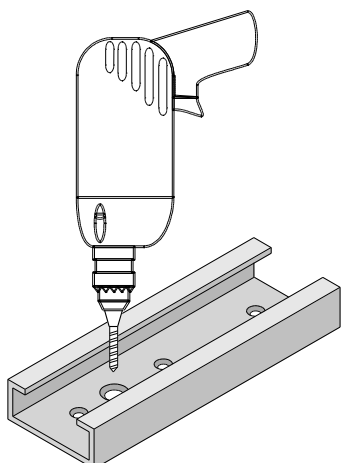

- The connecting wire and the 30 cm cable end with the integrated terminal resistor can be placed in the aluminium C-profile.

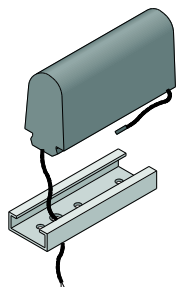

- In order to make fitting the safety contact edge easier, the aluminium C-profile and the safety contact edge should be sprayed with soapy water. Once the soap suds have evaporated the contact edge is firmly fitted in the C-profile.

NB! To prevent a subsequent slipping of the safety contact edge talcum powder, oils or similarly durable lubricants may not be used!

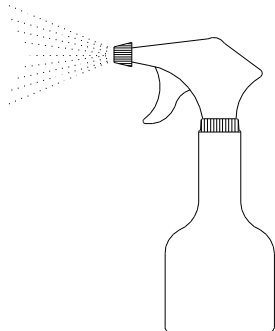

NB! Pulling or pushing the safety contact edge into the aluminium profile can cause damage to the contact edge and should be avoided at all costs. Any other proposed methods of adaptation should only be attempted after consultation with ABB Jokab Safety. Other methods of adaptation, unless approved by ABB Jokab Safety, may invalidate the warranty and may lead to incorrect device operation.

4 Connections

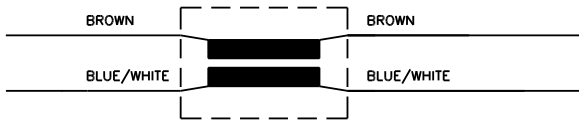

Contact edges must be connected to a suitable safety evaluation unit (e.g. ABB Jokab Safety safety relays RT6, RT7A/B, RT9, Vital with Tina 6A or Pluto safety-PLC).

The safety evaluation unit monitors the functionality of the contact protection and detects any breaks or short-circuits in the lines. Several crush protection units can be connected in series while still retaining the same level of safety.

When pressure is applied, the active surface of the contact area in the contact protection is closed and the safety output on the monitoring unit trips. A stop signal will be sent to the machine's safety circuits preventing any dangerous movements.

NB! If alternative units are used rather than the recommended ABB Jokab Safety relays, it is essential that the user checks their suitability before use. Failure to do so may result in incorrect operation and/or damage to the equipment and invalidate warranty.

Connection contact protection for safety relay RT6

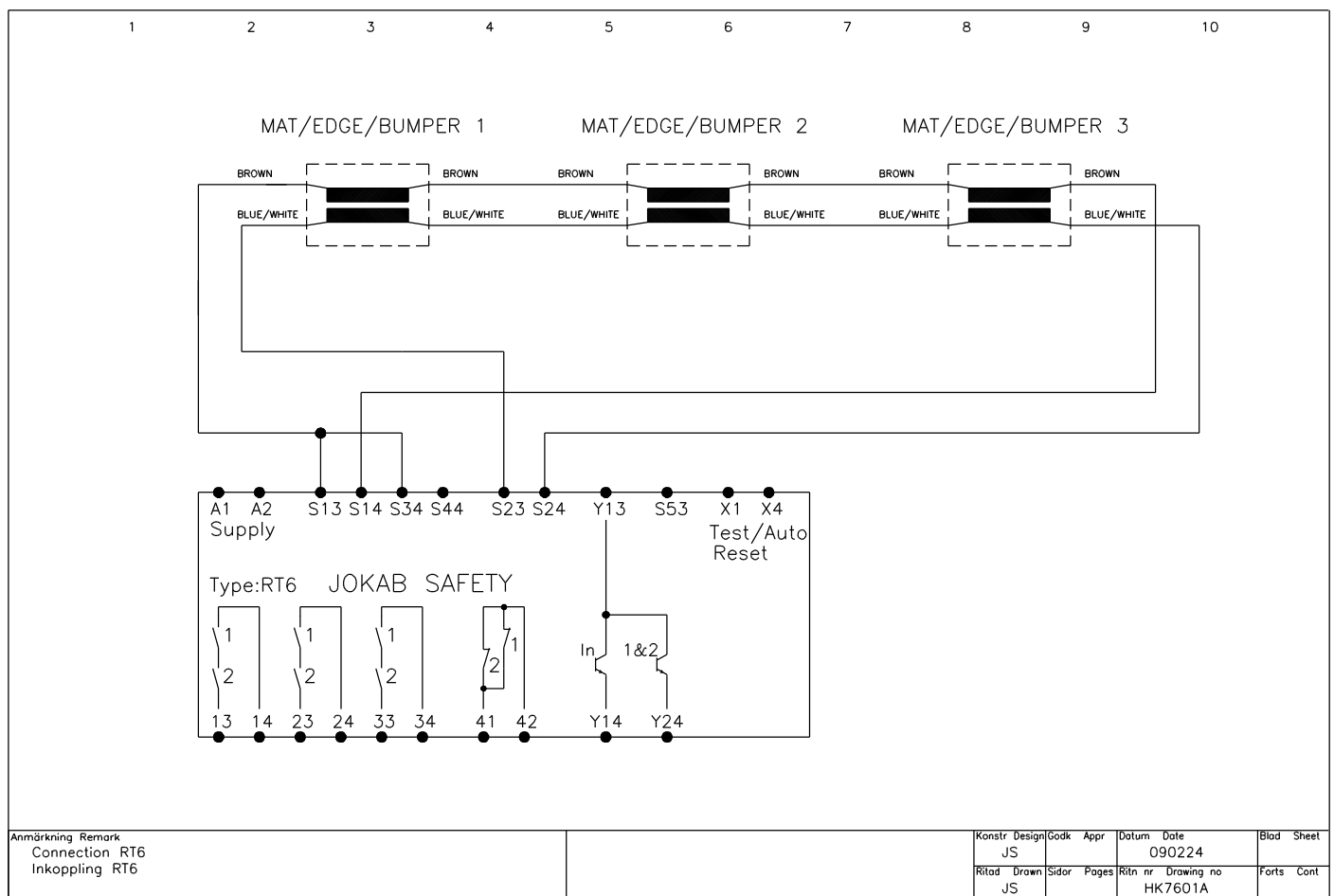

Connection contact protection for safety controller Vital 1

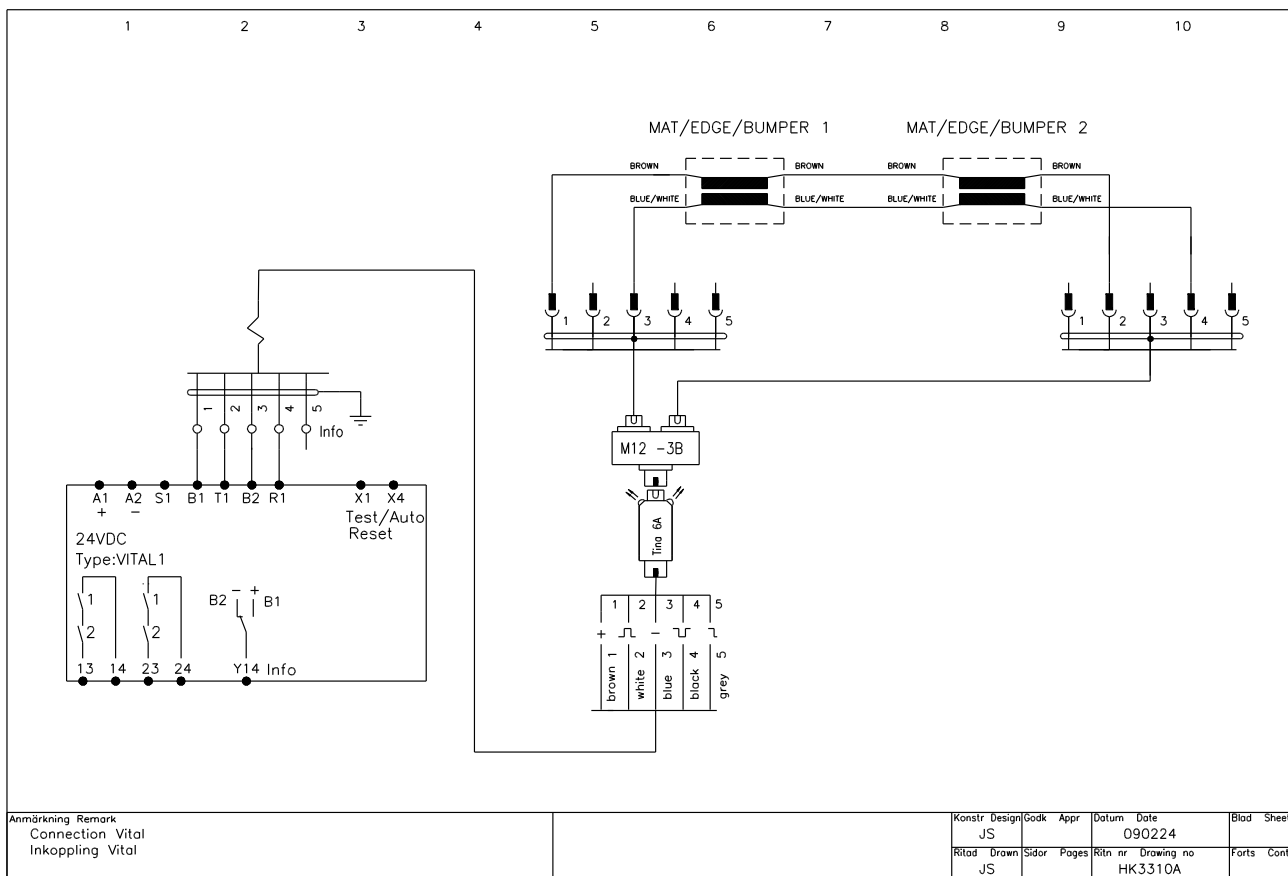

Connection contact protection for safety PLC Pluto

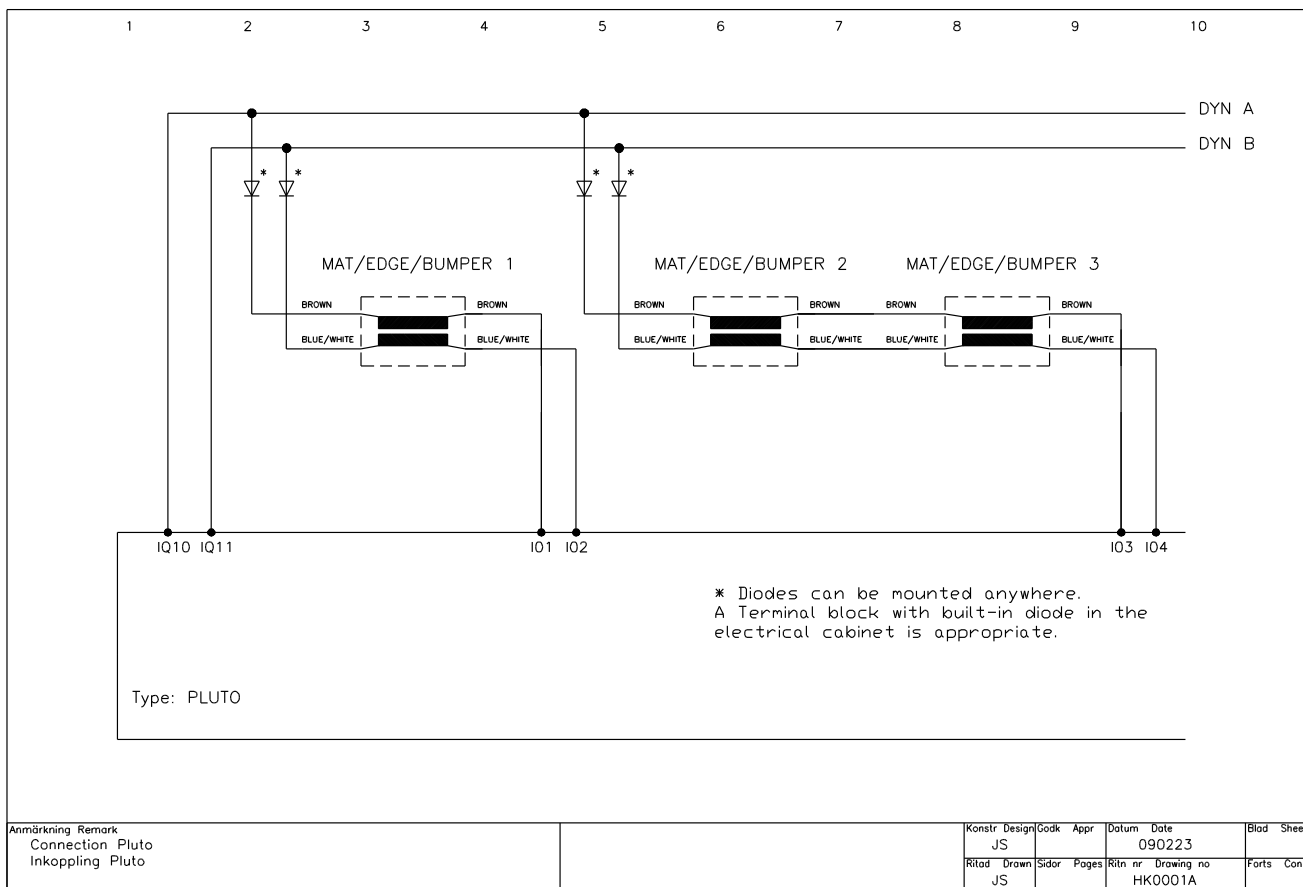

Installation precautions

 **Warning!** All the safety functions must be tested before starting up the system.

Maintenance

 **Warning!** The safety functions and the mechanics shall be tested regularly.

 **Warning!** In case of breakdown or damage to the product, contact the nearest ABB Jokab Safety Service Office or reseller. Do not try to repair the product yourself since it may accidentally cause permanent damage to the product, impairing the safety of the device which in turn could lead to serious injury to personnel.

Caution! ABB Jokab Safety will not accept responsibility for failure of the switch functions if the installation and maintenance requirements shown in this sheet are not implemented. These requirements form part of the product warranty.

5 Model overview

GE Contact edge

Ordering Contact Edge GE

When ordering a Contact Edge GE it's necessary to order every part specifically.

Type of contact edge(in meter), aluminium profile(in meter), connection plugs(one for each end) and end caps(one for each end). If manufactured by ABB Jokab Safety another article need to be added. Always specify length of safety edge. Accessories for GE is ordered separately.

Article number	Description
GE – Contact edge	
2TLA076005R0200	Contact edge GE 25-25 EPDM, per metre
2TLA076005R0400	Contact edge GE 25-45 EPDM, per metre

Accessories/Cables

Article number	Type
2TLA076002R0200	Al 25-14 aluminium profile
2TLA076005R4400	Connection plug with 2,5 m cable
2TLA076005R4500	Connection plug with 5 m cable
2TLA076005R4600	Connection plug with 10 m cable
2TLA076005R4700	Connection plug with resistor 8,2 Ω
2TLA076005R6100	End cap for GE25-45
2TLA076005R6200	End cap for GE25-25
2TLA076005R7600	Glueing set small 5 gr/5ml
2TLA076005R7700	Glueing set large 20 gr/10ml
2TLA076005R8500	Scissor
2TLA076005R8600	Plug insert tool
2TLA076008R0000	Production cost if GE contact edge assembled by ABB Jokab Safety

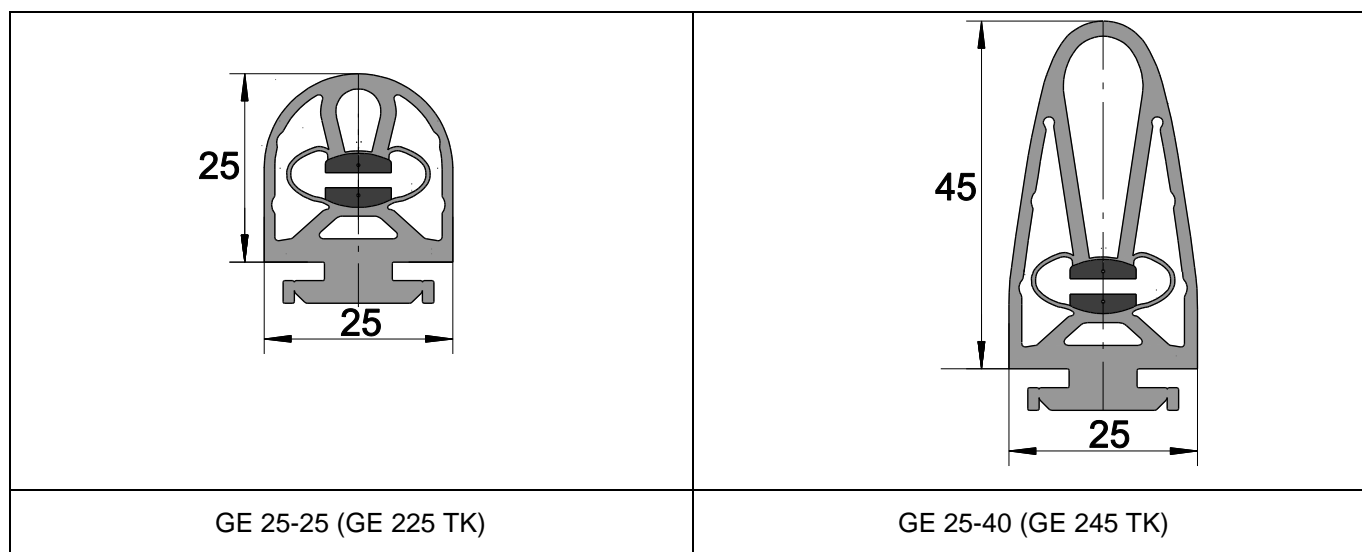

NB! Measurements are in mm.

GP Contact edge

Ordering Contact Edge GP

When ordering a Contact Edge GP it's made out of two parts. One article with production cost and cables and one article with type of contact edge in meter.
Always specify length of safety edge.

Article number	Description
GP – Contact edge including aluminium profile	
2TLA076025R2500	Contact edge GP25-25 EPDM, ordered by length
2TLA076125R2500	Contact edge GP25-25 NBR, ordered by length
2TLA076025R4000	Contact edge GP25-40, EPDM, ordered by length
2TLA076125R4000	Contact edge GP25-40, NBR, Ordered by length

Accessories/Cables

Article number	Type
2TLA076009R0100	Production cost, 2+2 m cable
2TLA076009R0200	Production cost, 2+5 m cable
2TLA076009R0300	Production cost, 2+7 m cable
2TLA076009R0400	Production cost 2+10 m cable
2TLA076009R0500	Production cost, 5+5 m cable
2TLA076009R0600	Production cost 5+7 m cable
2TLA076009R0700	Production cost 5+10 m cable
2TLA076009R0800	Production cost, 7+7 m cable
2TLA076009R0900	Production cost 7+10 m cable
2TLA076009R01000	Production cost, 10+10 m cable
2TLA076009R1100	Production cost x+x m cable. Cable not included. Add 2TLA076002R1800
2TLA076002R1800	Cable LIYY 2 x 0.34, meter

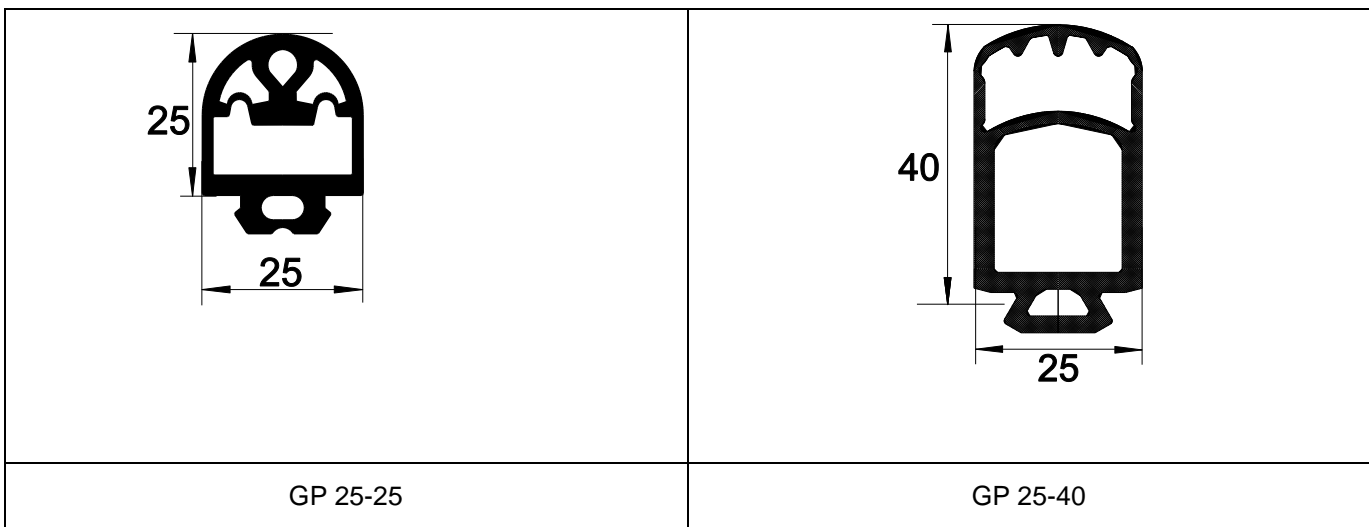

NB! Measurements are in mm.

6 Technical data

Manufacturer

Address ABB JOKAB SAFETY
Varlabergsvägen 11
S-434 91 Kungsbacka
Sweden

Safety contact strip SKS 18 for contact edge GP

Outer material	EPDM, electrical insulation >30 Mohm
Inner material	EPDM, electrical elastomer with reinforce copper wire
Conductivity	60Ω / 100 metres
Contact resistance	Approx. 50Ω
Max. Electrical load	24 v/100 mA
Max. applied pressure	6,5 N/cm ²
Dimensions	18 x 6 mm

Contact Edge GE and GP

Mechanical load max ¹	500 N
Actuation angle (DIN) ¹	2 x 20°
Mechanical life ¹	10 ⁵
Max. temperature range	-20° to +55° C
Protection classification	IP 65
Max. electrical load	24 V 100 mA
Resistance	0,6 Ohm/m
Conductors	GP: 2 x 0,38 mm ² GE: 2 x 0,34 mm ²
Conductors insulation material	GP: PVC, GE: PUR matt black

¹According to DIN 31006-2 (GS - BE -17) ²Not including DIN 31006-2 (GS - BE -17)

The Jokab Safety branded product with articlenumber beginning with 2TLJ is fully compatible with the ABB branded product with articlenumber beginning with 2TLA.

Rubber profiles

Type		GP 25-25	GP 25-40	GE 25-25	GE 25-45
Fixing profile		AL 25-14	AL 25-14	AI 25-14	AI 25-14
Material		EPDM/NBR	EPDM/NBR	EPDM	EPDM
Length max (m)	(1)	6(10)	6(10)	25	25
Weight (g/m)		370	480	510	770
Weight incl. C-profile (g/m)		690	800	820	1080
Activation force (N)	(2)	34/37	39/52	64,1	69,1
Actuation distance (mm)	(3)	8,0/7,5	9,4/9,7	4,7	6,73
Braking distance (mm)	(3)	7,2/5,9	10,2/9,5	6,48	20,73
Switching Angle (°)	(4)	2x45°	2x30°	2x30°	2x45°

1 10 meters lengths of GP edges on request

2 Measured with (Ø 80 mm test specimen), 10 mm/s

3) Measuring speed 10 mm/s

4) Not including DIN 31006-2 (GS – BE – 17)

Physical and chemical material properties

Properties:	EPDM	NBR
Tensile strength	3	2
Tensile elongation	3	2
Durability	3	2
Tear resistance	3	3
Cold flexibility	2	3
Heat resistance	2	2
Oxidation resistance	1	3
UV-resistance	1	3
Weather/ozone resistance	1	3
Flame resistance	6	6
Gas permeability	4	2
Resistance:		
Water (distilled)	1-2	1
Acids (diluted)	1	3
Bases (diluted)	2	2
Non-oxidised acids	2	3
Oxidised acids	4	5
ASTM oil No. 3	6	1
Vegetable oil	5	1
Ester solvent	2	5
Ketone solvent	3	5
Aliphatic hydrocarb.	5	1
Aromatic hydrocarb.	6	2-3
Halogenic hydrocarb.	6	5
Alcohols	1	5

1= no effect	for lasting contact
2= slight effect	non-lasting contact
3= moderate effect	moderate contact
4= appreciable effect	limited contact
5=strong effect	short-term contact
6= extreme effect	avoid contact
EPDM	Good resistance to ozone and weather, especially against chemicals
NBR	Good resistance to oil and petrol
ASTM	American Society for Testing Material
Kw	Aromatic hydrocarbon
Ester	Organic solvent
Ketone	Oxidized solvent
Aliphatic	i.e. petrol
Aromatic	i.e. benzol

NB! The information given is based on data obtained from the respective material suppliers. Although all efforts have been made, unforeseen factors can have a considerable effect on the generally applied indications during practical use therefore this information must be used as a general guide only. If there is any doubt as to the suitability of the materials used for any specific application/environment, we will, upon request, supply rubber samples for your own evaluation.

GE – Bending angles and radii

The aluminum C-profile has to be prepared at the factory if it has to be bent.

GE – Bending angles for different assembly arrangements

Type	A	B	C
GP 25-25 (GE 225 TK)	45°	20°	30°
GP 25-40 (GE 245 TK)	45°	10°	20°

GE – Bending radii for different assembly arrangements

Type	Figure 2	Figure 3	Figure 4
GP 25-25 (GE 225 TK)	300	400	200
GP 25-40 (GE 245 TK)	400	500	200

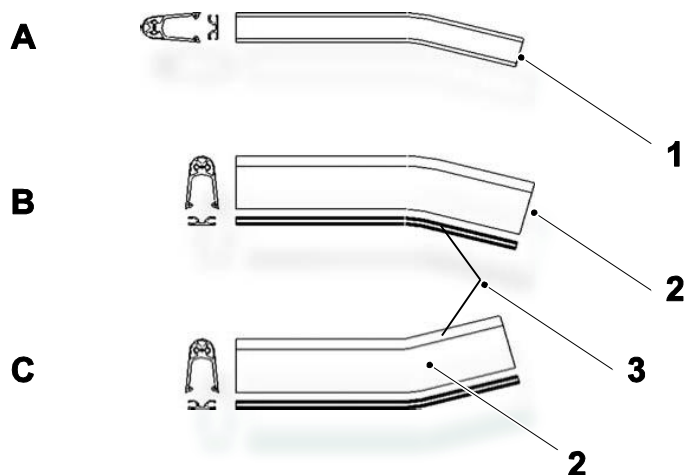

Figure 1

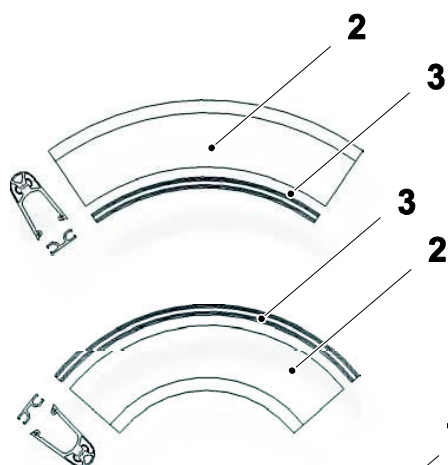

Figure 2

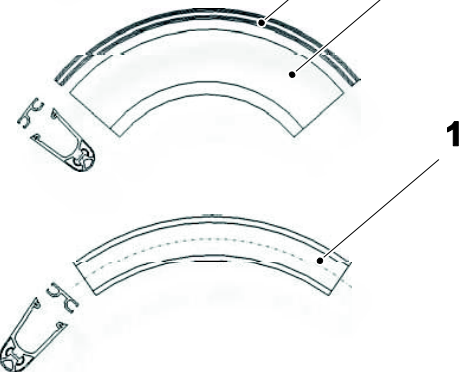

Figure 3

Figure 4

- 1. Side view
- 2. Top view
- 3. Alu C-profile

GP – Bending angles and radii

The aluminum C-profile has to be prepared at the factory if it has to be bent.

GP – Bending angles for different assembly arrangements*

Figure 1			
Type	A	B	C
GP 25-25	35°	20°	20°
GP 25-40	30°	15°	15°

GP-Bending radii for different assembly arrangements*

Type	Figure 2	Figure 3	Figure 4
GP 25-25	300	400	200
GP 25-40	500	700	300

NB! * Bending angle and radii are not part of the tests complying with DIN 31006/2 and GS-BE 17

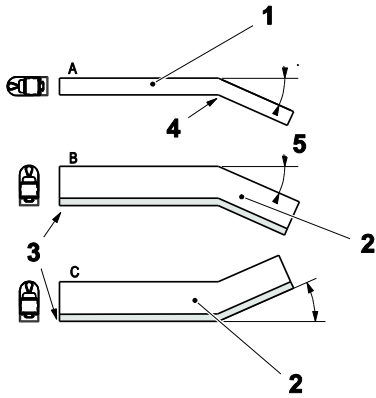

Figure 1

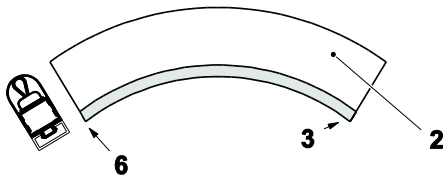

Figure 2

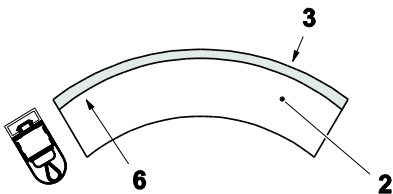

Figure 3

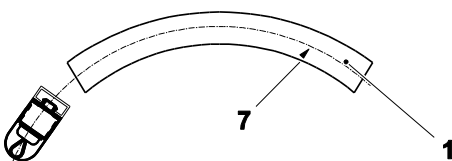

Figure 4

1. Top view
2. Side view
3. Alu C-profile
4. Bending point
5. Bending angle
6. Bending radius of the c-profile's bottom edge
7. Bending radius of the c-profile's centre

7 EC Declaration of conformity



EC Declaration of conformity

(according to 2006/42/EC, Annex 2A)

We ABB AB
JOKAB Safety
Varlabergsvägen 11
SE-434 39 Kungsbacka
Sweden

declare that the safety components of ABB AB make with type designations and safety functions as listed below, is in conformity with the Directives
2006/42/EC
2004/108/EC

Authorised to compile the
technical file

ABB AB
JOKAB Safety
Varlabergsvägen 11
SE-434 39 Kungsbacka
Sweden

Product

Safety rails

GE 15-25 TT (GE 125 TT),

GE25-25 (GE 225 TK),

GE 25-45 TK (GE 245 TK),

GE 35-65 CK (GE 365 CK),

F45, F50, F56, F65, F85,

F115 (all versions)

With Safety Relays/Safety PLC

RT6, RT7A/B, RT9, Vital 1 and Tina 6, Pluto

Used harmonised standards

With RT6, RT7A/B, RT9

EN 1780-2+A1:2009, EN ISO 12100:2010, EN ISO 13849-1:2008, EN 62061:2005,

EN 60204-1:2008+A1:2009, EN 60664-1:2007, EN 61000-6-2:2005,

EN 61000-6-3:2007, EN 60947-5-1:2003+A1:2009

With Vital 1 and Tina 6

EN 1780-2+A1:2009, EN ISO 12100-1:2010, EN ISO 13849-1:2008, EN 62061:2005,

EN 60204-1:2008+A1:2009, EN 61000-6-2:2005, EN 61000-6-4:2007,

EN 61496-1+A1:2008

With Pluto

EN 1780-2+A1:2009, EN ISO 13849-1:2008+AC:2009, EN 62061:2005,

EN 61496-1:2008+A1:2008, EN 574:1996+A1:2008, EN 692:2005+A1:2009,

EN 60204-1:2008+A1:2009, EN 50178:1997, EN 61000-6-2:2005,

EN 61000-6-4:2007, EN 61000-4-1...6

Other used standards

EN 61508:2010 (With RT6, RT7A/B, RT9, Vital 1 and Tina 6, Pluto)

Jesper Kristensson
PRU Manager
Kungsbacka 2012-05-25

www.abb.com
www.jokabsafety.com

Original

EC Declaration of conformity

(according to 2006/42/EC, Annex 2A)

We ABB AB
JOKAB Safety
Varlabergsvägen 11
SE-434 39 Kungsbacka
Sweden

declare that the safety components of ABB AB make with type designations and safety functions as listed below, is in conformity with the Directives
2006/42/EC
2006/95/EC
2004/108/EC

Authorised to compile the
technical file

ABB AB
JOKAB Safety
Varlabergsvägen 11
SE-434 39 Kungsbacka
Sweden

Product

Safety rails
GP 25-25, 25-40, 25-65, 35-60,
35-80, 35-105
(all versions)

With Safety Relays/Safety PLC

RT6, RT7A/B, RT9, Vital 1 and Tina 6, Pluto

Used harmonised standards

With RT6, RT7A/B, RT9

EN 1760-2+A1:2009, EN ISO 12100:2010, EN ISO 13849-1:2008, EN 62061:2005,
EN 60204-1:2006+A1:2009, EN 60664-1:2007, EN 61000-6-2:2005,
EN 61000-6-3:2007, EN 60947-5-1:2003+A1:2009

With Vital 1 and Tina 6

EN 1760-2+A1:2009, EN ISO 12100-1:2010, EN ISO 13849-1:2008, EN 62061:2005,
EN 60204-1:2006+A1:2009, EN 61000-6-2:2005, EN 61000-6-4:2007,
EN 61496-1+A1:2008

With Pluto

EN 1760-2+A1:2009, EN ISO 13849-1:2006+AC:2009, EN 62061:2005,
EN 61496-1:2008+A1:2008, EN 574:1996+A1:2008, EN 692:2005+A1:2009,
EN 60204-1:2006+A1:2009, EN 50178:1997, EN 61000-6-2:2005,
EN 61000-6-4:2007, EN 61000-4-1...6

Other used standards

EN 61508:2010 (With RT6, RT7A/B, RT9, Vital 1 and Tina 6, Pluto)

Jesper Kristensson
PRU Manager
Kungsbacka 2012-05-25

www.abb.com
www.jokabsafety.com

Original